

EAGLE AUTOMATION LIMITED
 RESERVE THE RIGHT TO MODIFY
 THE DESIGN WITHOUT NOTICE

2670
 PLINTH

DRAWN TO B.S. 8888

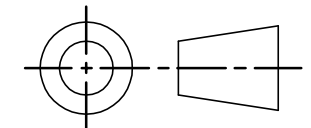

THIRD ANGLE PROJECTION

METHOD OF OPERATION

THE TURNSTILE AND GATE ARE BI-DIRECTIONAL ONCE THE USER HAS AUTHORISED BY EITHER AN ACCESS CONTROL SYSTEM OR PUSH BUTTON CONTROL FROM A REMOTE LOCATION THE TURNSTILE WILL UNLOCK ENABLING THE USER TO ADVANCE THROUGH THE TURNSTILE, ADDITIONALLY IF REQUIRED THE USER HAS THE OPTION OF AUTOMATICALLY UNLOCKING THE GATE AND MOTORISING TO THE OPEN POSITION BY PUSHING A PUSH BUTTON LOCATED ON EITHER SIDE OF THE TURNSTILE FRAME WHICH IS ONLY ACTIVE IF USER HAS BEEN CLEARED TO PASS THROUGH THE TURNSTILE.

THE DISMOUNTED CYCLIST WOULD PASS THROUGH THE TURNSTILE PUSHING THE CYCLE THROUGH THE OPENED GATE. ONCE THE TURNSTILE ROTOR HAS COMPLETED ITS ROTATION IT WILL AUTOMATICALLY LOCK, THE GATE WILL REMAIN OPEN FOR A LONGER DURATION TO ALLOW THE CYCLE TO CLEAR THE GATE AND PHOTO CELLS. (ADJUSTABLE OPEN TIME).

THE GATE WILL AUTOMATICALLY (MECHANICALLY) CLOSE AND RELOCK AFTER THE PRE-SET TIME HAS ELAPSED.

IN THE CLOSED POSITION THE TURNSTILE AND GATE ARE ELECTRICALLY LOCKED.

BOTH THE TURNSTILE AND GATE FAIL UNLOCKED IN THE EVENT OF POWER FAILURE (FAIL LOCKED OPTION AVAILABLE).

TYPICAL CYCLE PROFILE

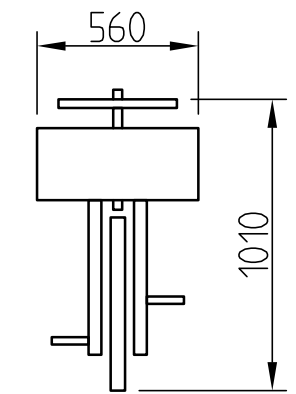

M10 RAWL BOLT
 HEX HEAD BOLT ST.STL
 TIGHTEN TO 27Nm max

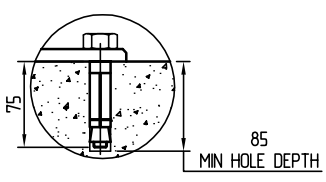

THE CUSTOMER TO ENSURE A SUITABLE STRUCTURED OPENING FOR MOUNTING, WITH FREE STANDING STRONG POINT BY MEANS OF THE NORMAL ANCHORAGE SPECIFIED BY THE MANUFACTURE.

APPROX. POSITION FOR
 Ø50 CONDUIT EMERGENCE
 1520
 175
 335
 40
 674
 CYCLE
 TURNSTILE WALKWAY
 CYCLE GATE
 1570 FRAME
 1870
 PLINTH
 150
 150
 766
 PEDESRIAN
 2370 FRAME

PLAN VIEW

(OMITTING CANOPY FOR CLARITY)
 CANOPY SPLIT SUPPORTED

FIXING DETAIL

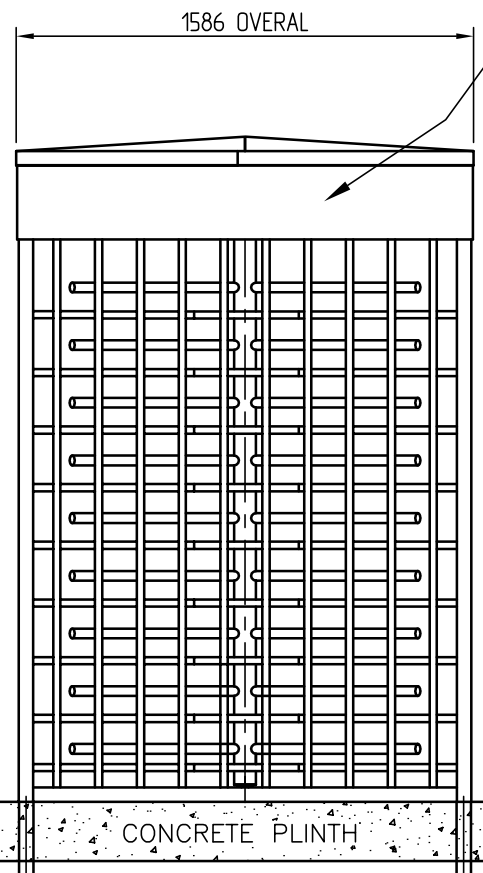

NOTE :-
 NORMALLY THE POWER SUPPLY UNIT AND CONTROL BOARD ENCLOSURE ARE CONTAINED WITHIN THE CANOPY. CABLES TO THIS AREA (MAINS SWA AND SIGNAL CABLES) ARE DUCTED THROUGH VERTICAL SECTIONS OF THE TURNSTILE.

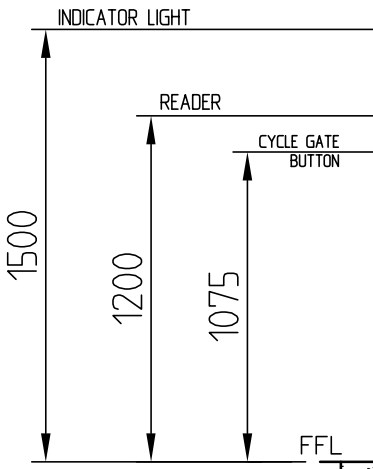

FRONT ELEVATION

SIDE ELEVATION

MAINS POWER 230VAC 6AMP
 AND SIGNAL CABLE
 CONDUITS

ISSUE	DATE	CHANGE NOTE
C	30-10-09	GATE CHANGED TO NEW DESIGN
B	14-03-08	PROD ISSUE
A	31.01.08	INITIAL ISSUE
DRAWN	M.KEADY	CHECKED
		CERTD.
		SCALE
		N.T.S

PROTECTIVE FINISH	-
TOLERANCES FOR DIMENSIONS	
DIMS. SHOWN THUS >449	±1
DIMS. SHOWN THUS 1.	±0.4
DIMS. SHOWN THUS 1.0	±0.15
DIMS. SHOWN THUS 100	±0.05
UNLESS OTHERWISE STATED	
ALL DIMENSIONS IN MILLIMETRES	

MATERIAL	-
STORES REF.	-
TITLE	COMBINED PEDESTRIAN AND CYCLE ENTRANCE PLINTH DETAILS

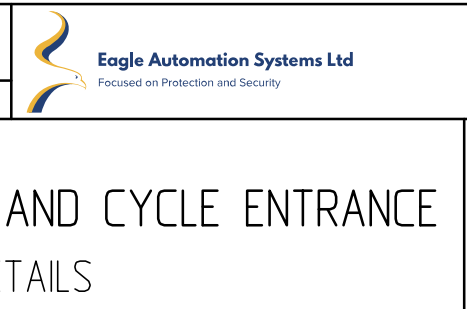

DRG.No.	481-200
	A3